

Oil & Gas Lease Oral Auction

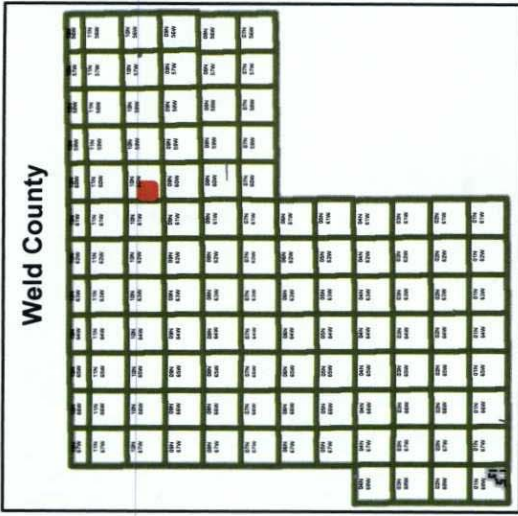

LEO292
S20 T10N R60W

Southwest 1/4 Section 20,
Township 10 North, Range 60 West

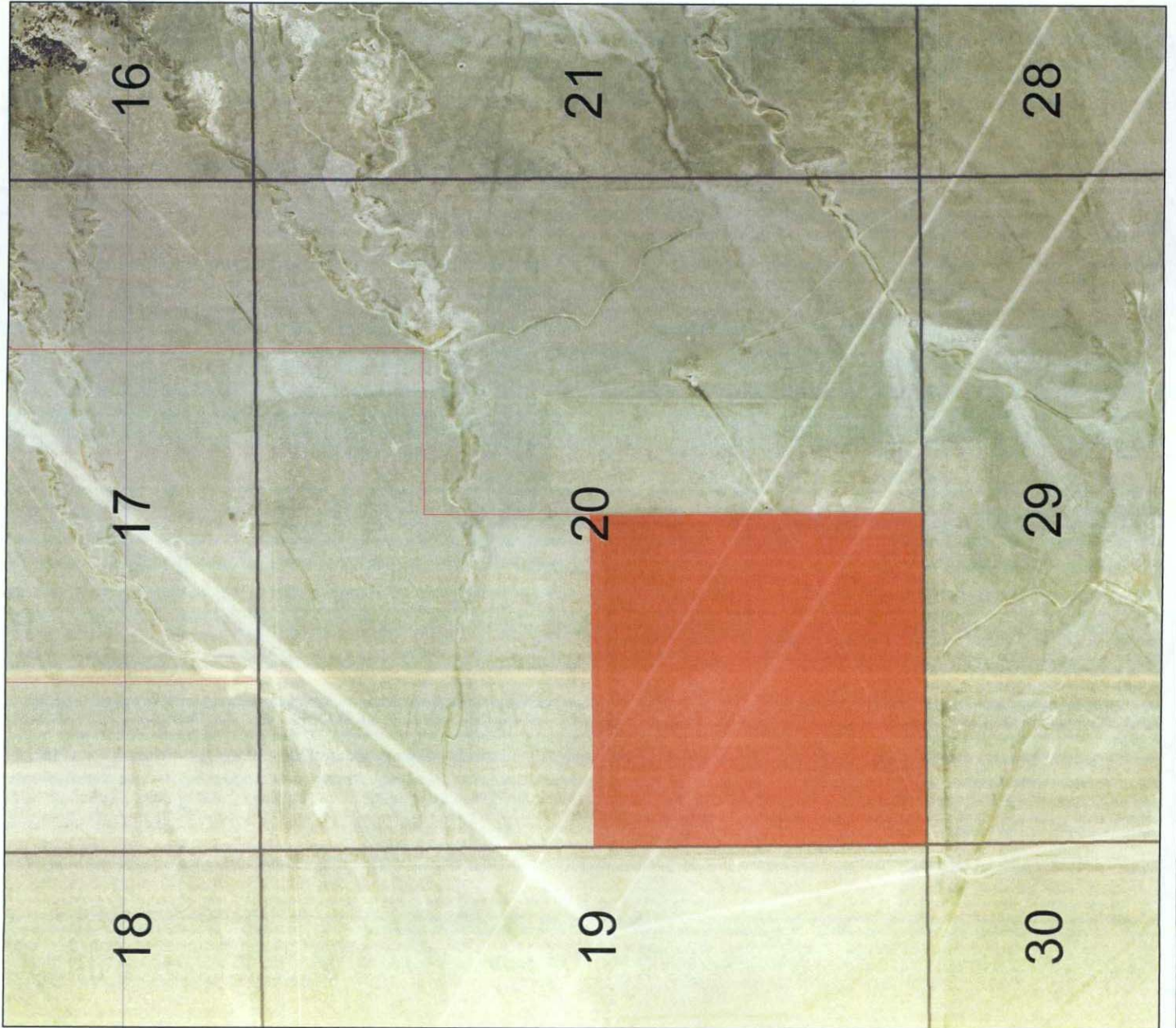

Parcel

SW1/4 S20 T10 R60

1 inch = 1,234 feet

Disclaimer
This product has been developed solely for informational purposes only by Weld County. The GIS database and data in the product is subject to change and is not guaranteed. The designation of lots or parcels or land uses in the data base does not imply that the lots or parcels were legally created or that the land uses comply with applicable State laws, regulations, codes, ordinances, or other governmental actions. WELD COUNTY MAKES NO WARRANTIES OR GUARANTEES, EITHER EXPRESSED OR IMPLIED AS TO THE COMPLETENESS, ACCURACY, OR CORRECTNESS OF SUCH PRODUCT, NOR ACCEPTS ANY LIABILITY ARISING FROM THE USE OF THE PRODUCT. THE INFORMATION CONTAINED HEREIN IS PROVIDED "AS IS" WITHOUT WARRANTY OF ANY KIND, INCLUDING MERCHANTABILITY, FITNESS FOR A PARTICULAR PURPOSE, OR BY ANY MEANS, WHETHER IN WRITING OR ORALLY. No part of the product may be reproduced, stored in a retrieval system, or by any scanning, or by any information retrieval system or any non-approved purpose without the express written consent of Weld County.