

Oil & Gas Lease Oral Auction

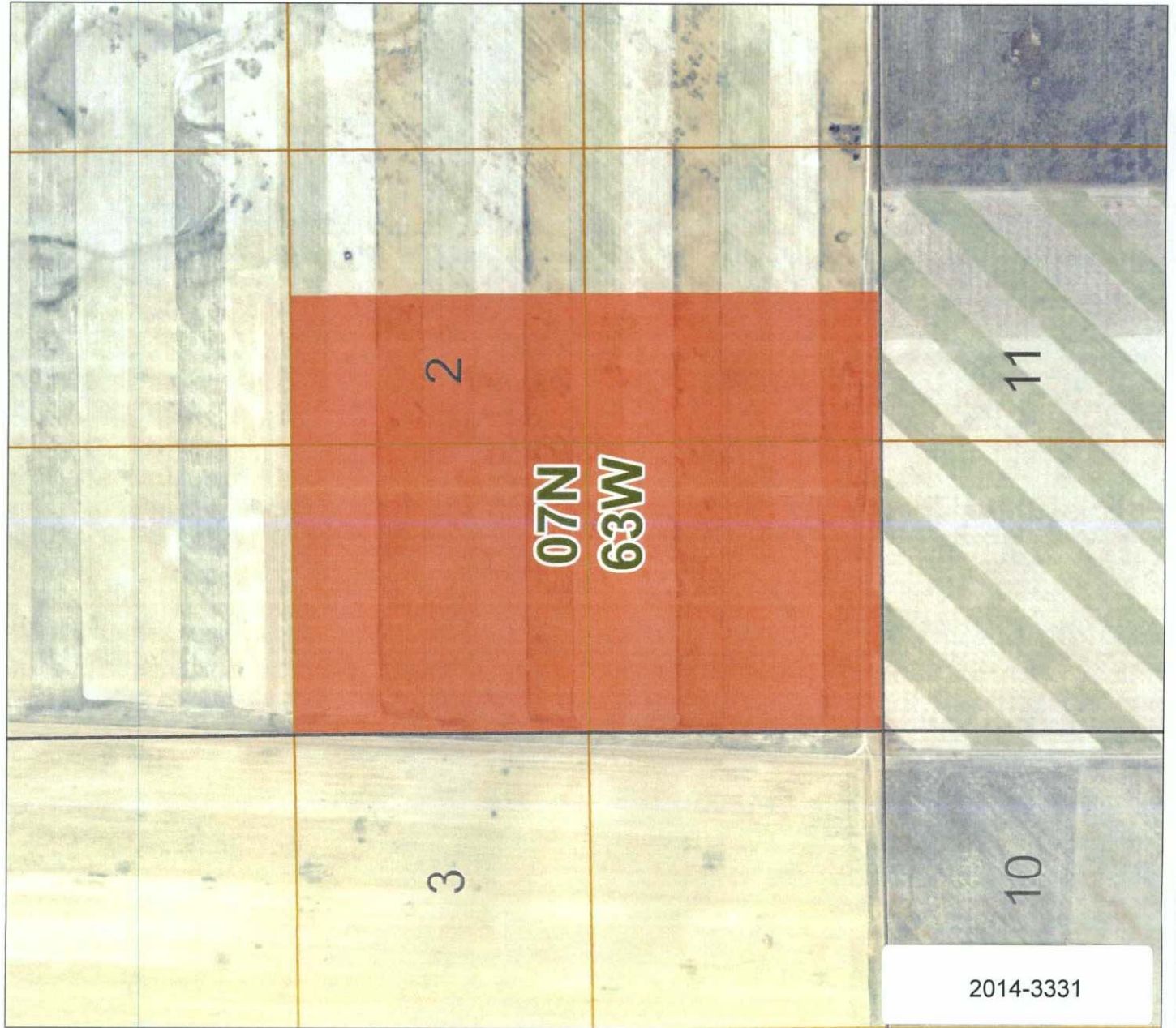

2014-3331

Weld County

04N	05N	06N	07N	08N	09N	10N	11N	12N	60W	61W	62W	63W	64W	65W	66W	67W	68W
04N	05N	06N	07N	08N	09N	10N	11N	12N	60W	61W	62W	63W	64W	65W	66W	67W	68W
03N	04N	05N	06N	07N	08N	09N	10N	11N	59W	60W	61W	62W	63W	64W	65W	66W	67W
03N	04N	05N	06N	07N	08N	09N	10N	11N	58W	59W	60W	61W	62W	63W	64W	65W	66W
02N	03N	04N	05N	06N	07N	08N	09N	10N	57W	58W	59W	60W	61W	62W	63W	64W	65W
02N	03N	04N	05N	06N	07N	08N	09N	10N	56W	57W	58W	59W	60W	61W	62W	63W	64W
01N	02N	03N	04N	05N	06N	07N	08N	09N	55W	56W	57W	58W	59W	60W	61W	62W	63W
01N	02N	03N	04N	05N	06N	07N	08N	09N	54W	55W	56W	57W	58W	59W	60W	61W	62W
01N	02N	03N	04N	05N	06N	07N	08N	09N	53W	54W	55W	56W	57W	58W	59W	60W	61W
01N	02N	03N	04N	05N	06N	07N	08N	09N	52W	53W	54W	55W	56W	57W	58W	59W	60W
01N	02N	03N	04N	05N	06N	07N	08N	09N	51W	52W	53W	54W	55W	56W	57W	58W	59W
01N	02N	03N	04N	05N	06N	07N	08N	09N	50W	51W	52W	53W	54W	55W	56W	57W	58W

S2 T7N R63W

W2SW4 & W2E2SW4
120 acres

 Township / Range
 Section
 Quarter section



1 inch = 700 feet

Disclaimer
 This product has been developed solely for internal use only by Weld County. The GIS database and data in the product is subject to constant change and the accuracy and completeness cannot be and is not guaranteed. The designation of lots or parcels or land uses in the data base does not imply any official action or approval by Weld County. This product is not to be used for any legal, State or Local law, JUDICIAL PROCEEDINGS, ESTATE MATTERS, TITLE CURATIVE, INTERESTS, EASEMENTS, DESIGN PURPOSES. WELD COUNTY MAKES NO WARRANTIES OR GUARANTEES, EITHER EXPRESSED OR IMPLIED AS TO THE COMPLETENESS, ACCURACY OR RELIABILITY OF THIS PRODUCT. WELD COUNTY SHALL NOT BE HELD RESPONSIBLE FOR ANY INCOMPLETE, ACCURATE, MISLEADING INFORMATION. No part of the product may be copied, reproduced or transmitted in any form or by any means whatsoever, including, but not limited to, electronic, mechanical, photocopying, recording, scanning, or by any information retrieval system or any non-approved purpose without the express written consent of Weld County.